

## LEGEND

# Pre-Delivery Guide

Preparing the way  
for your new Covana spa cover



**LEGEND** swim spa cover



## A new level of luxury!

Easy access to your swim spa with protection against the weather and ultraviolet radiation while providing you with a luxurious vibe.

## In this Pre-Delivery Guide:

Swim spa compatibility .....	3
Color options .....	5
Choosing the perfect location .....	6
Laying the right foundation.....	7
Electrical specifications .....	8
Planning the delivery .....	9
Notes .....	11

*Less effort, more comfort for a longer time:  
A promise signed Covana.*

# Swim spa compatibility



Most rectangular swim spas with a **flat surface (no protruding headrests)** and the following features:

- Spa wall on both sides must be flat and parallel.
- The seal of the cover will have to be installed on a flat surface of at least 1" (2.5 cm) wide, on the acrylic of the spa. The minimum turn radius of the seal is 4" (10 cm). Ensure the seal will be able to go all around the spa while continuously touching the cover.

No protruding headrests

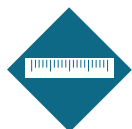
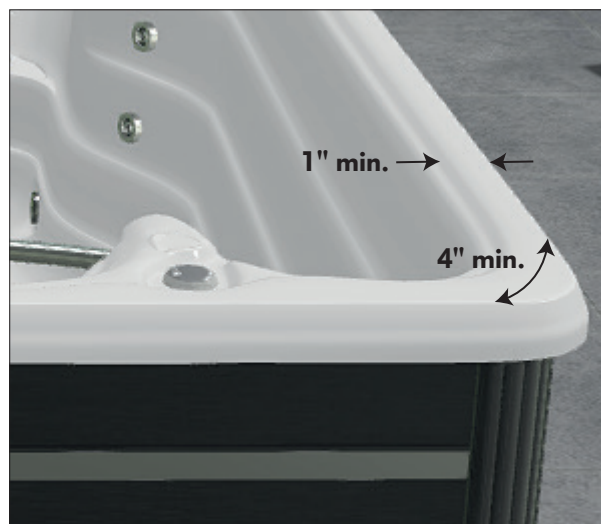

Refer to the table below to choose the appropriate model according to the length of your swim spa. If you don't know which model to choose, or if you are unsure whether your swim spa will fit under the cover or not, please contact Covana for the Technical Support department: 1-877-278-8010.

SWIM SPA MAXIMUM LENGTH	LEGEND COVER	✓
146.25" (371.5 cm)	12 ft (3.66 m)	
158.25" (402 cm)	13 ft (3.96 m)	
170.25" (432.4 cm)	14 ft (4.27 m)	
182.25" (463 cm)	15 ft (4.57 m)	
194.25" (493.4 cm)	16 ft (4.88 m)	
206.25" (523.9 cm)	17 ft (5.18 m)	
218.25" (554.4 cm)	18 ft (5.49 m)	
230.25" (584.8 cm)	19 ft (5.79 m)	
241.25" (612.8 cm)	20 ft (6.1 m)	

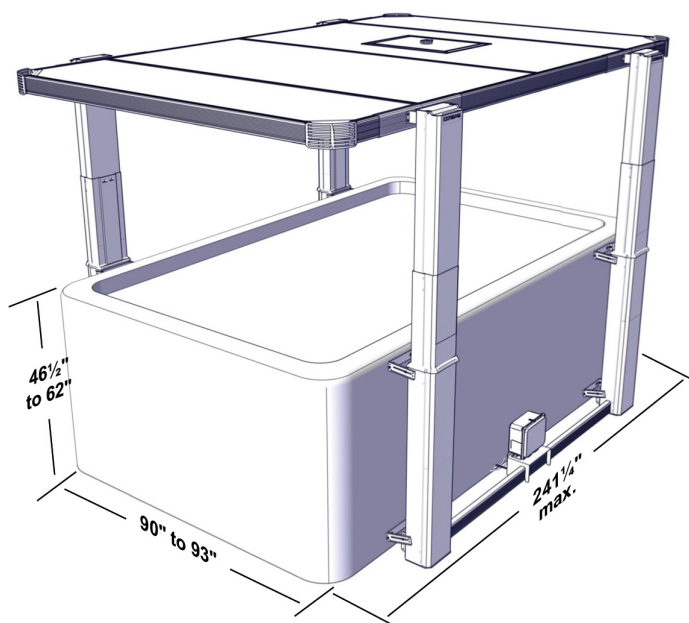

# Swim spa compatibility (continued)

Depending on your swim spa height and its frame height, one or two types of bracket might be needed. Refer to the tables below to see if it is the case.

The Legend cover must be installed **at the same ground level as the swim spa**.

A	BRACKETREQUIRED	<input checked="" type="checkbox"/>
46.5" to <49.5" (118 cm to <126 cm)	Dual side bracket	
49.5" to 61" (126 cm to 155 cm)	None	
>61" to 62" (>155 cm to 158 cm)	Dual side bracket	

B	BRACKETREQUIRED	<input checked="" type="checkbox"/>
<50" (127 cm)	None	
≥50" (127 cm)	Extended bracket	

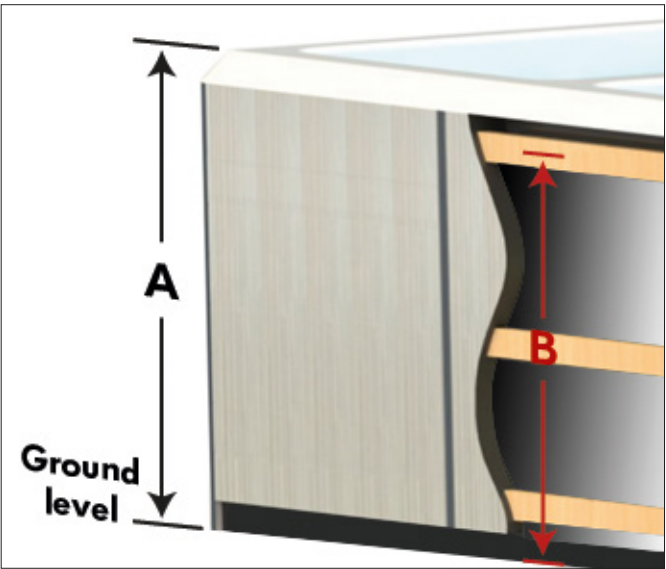

If your swim spa has two sections, similar to the swim spa illustrated below, the installation of two escape hatches is mandatory.

SWIM SPA SECTIONS	ESCAPE HATCH(ES) REQUIRED	<input checked="" type="checkbox"/>
1	1	
2	2	





# Color options



For a slight extra on the price of the regular white pannel, this option allows you to better match the color of your Covana with your environment. A little detail that can make a big difference.

Customize your cover by choosing between the following options:

(Actual colors may vary from images shown.)

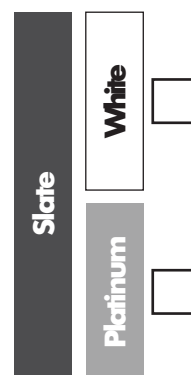
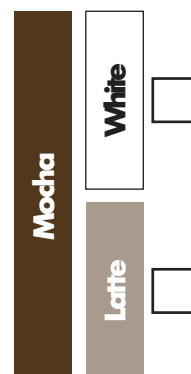

# Choosing the perfect location

- The Covana cover can be installed either indoors or outdoors.
- Away from flood zone, water downpours or debris falling.
- Wind speeds should not exceed 25 mph (40 km/h) in the raised position.
- Operating area must be free from obstacles, i.e., branches or electrical power lines.
- Allow for safe access to the spa, free of obstacles or debris.
- Sunlight must not converge or be directly reflected on the cover such as the reflection from a window.
- The surface must be clean and free of any vegetation (i.e., grass, branches, roots) and mineral contaminants (i.e., rocks, dust, sand).
- The key switch must be permanently mounted and located 5 ft away from the spa and 5 ft above the deck or ground level in a location where no water downpour or debris could fall on it.
- The user must have a clear view of the cover when operating it (25 ft / 7.6 m cable).

**SCAN ME!**

Legend  
Installation prep.

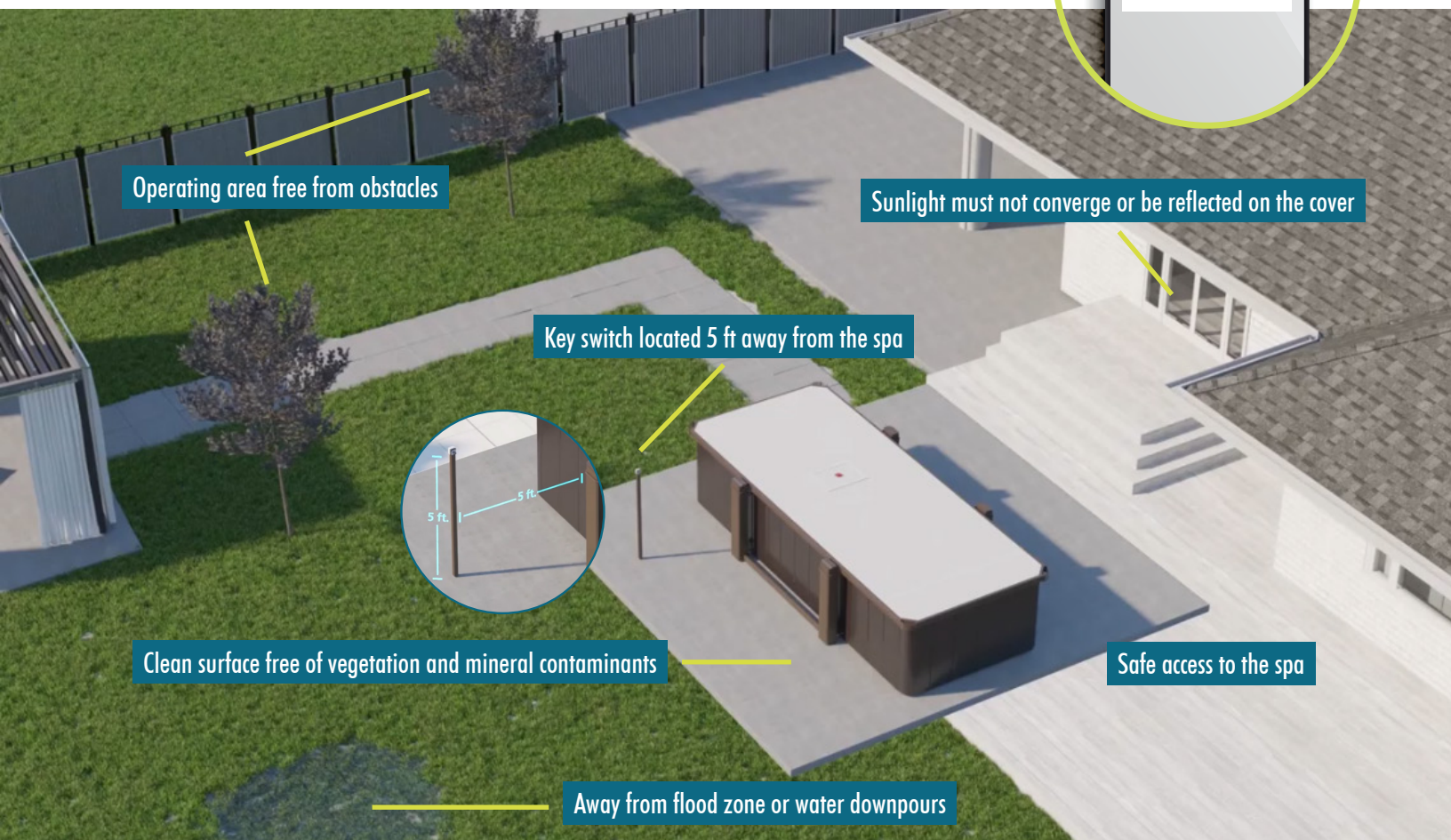

# Laying the right foundation

- A clean, flat and level surface such as a concrete slab is needed.
- The cover must be installed on the spa foundation. When not possible, a concrete pier or some cover support dedicated slabs must be provided.
- The four jacks of the cover will have to be properly fastened to the spa frame.
- Allow for at least 24" (60 cm) of clearance for maintenance on the posts sides, and 18" (45 cm) on the other sides.
- The foundation must be able to support at least 1,000 lb (454 kg).
- Any water accumulating around the cover will have to be drained.

## MINIMUM BASE SIZE

Contact Covana if the foundation is already in place and its dimensions are smaller than those illustrated below.

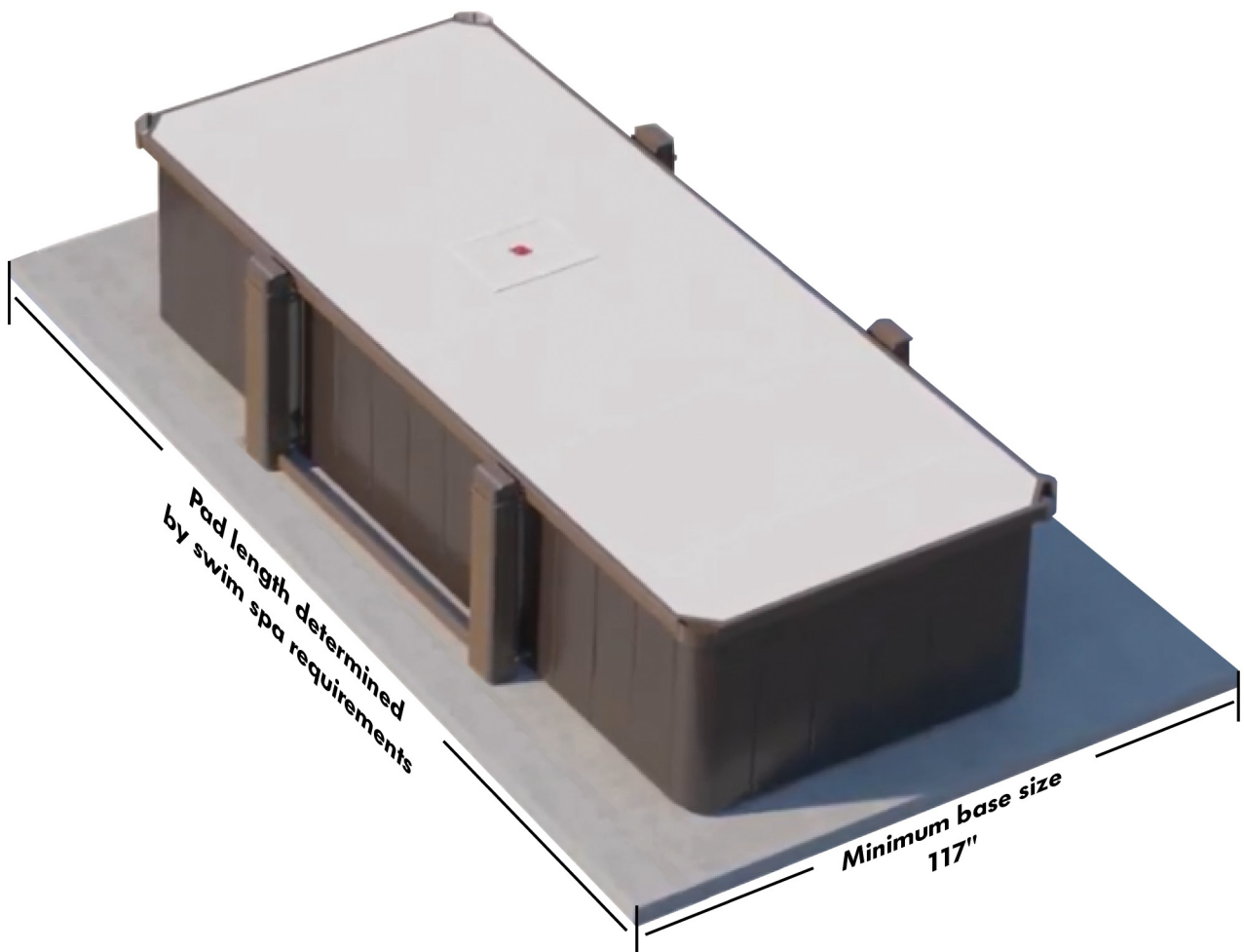

# Electrical specifications

- All electrical work should be done by a certified electrician, otherwise the certification and warranty will be void.
- The cover must be installed in accordance with and comply with all applicable local codes and regulations.
- Wires and conduits should be sized according to local codes and regulations.



## AC OPERATED MODEL

The cover requires a dedicated single-phase 115 VAC (North America).

### North American requirements

Voltage	115 V, 60 Hz (1 hot, 1 neutral, 1 ground)
GFCI	15 A single-pole GFCI (not included)
Current draw	Max 3 A



## BATTERY OPERATED MODEL

For the North American market, the standard AC powered system can be replaced with the optional battery-powered version which includes a set of two batteries and a solar panel to enhance their performance.

### North American requirements

Voltage	24 VDC System
Wall outlet voltage	115 VAC for charger
Battery	24 V DC, 12 Ah, AGM sealed lead-acid battery

### Australian/European/New-Zealand requirements

Voltage	24 VDC System
Wall outlet voltage	230 VAC for charger
Battery	24 V DC, 12 Ah, AGM sealed lead-acid battery

MARKET	MODEL	<input checked="" type="checkbox"/>
Australia/Europe/New Zealand	Battery operated model	
North America	AC operated model	
	Battery operated model with solar panel	



# Planning the delivery



The Legend cover will be delivered in a wooden crate. Take the time to sketch out a quick map from the delivery point to the installation point for the delivery personnel. You can also disassemble the unit from the crate at the delivery point and move the parts by hand.



Approximate dimensions for reference only.

# Planning the delivery (continued)

Use this simple checklist to plan the delivery route.

Measure the width of stairs and steps to get up and over

Are there railings in the way, and how wide apart are they

Measure to see if shrubs or trees are an obstacle

Ensure sidewalks are free of objects and clutter

Check the doghouse or shed to see available clearance

Check for uneven ground or slippery slopes

Measure for overhanging gutters or downspouts

Gate measurement for clearance

Recreational vehicles and cars in the driveway

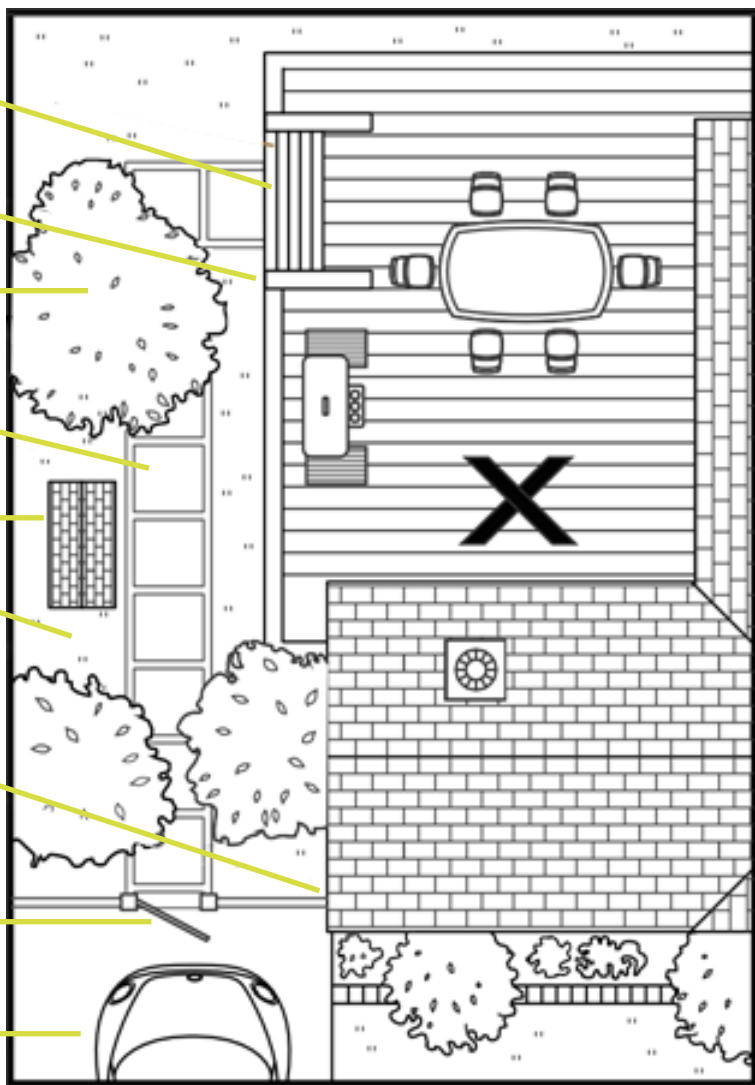

- ☐ automobiles / recreational vehicles
- ☐ gutter / fascia / soffit overhang
- ☐ electrical / gas meter equipment
- ☐ doghouse / playhouse
- ☐ stairs / steps / railings
- ☐ uneven ground
- ☐ slippery slope or path

- ☐ trees / foliage / shrubs
- ☐ patio furniture / deck chairs
- ☐ fences or narrow gates
- ☐ gravel, rocks or wood piles
- ☐ adequate access to wood decks
- ☐ door openings (if applicable)
- ☐ sheds or built-in structures

## Notes





## Your heaven of relaxation and privacy

The manufacturing process and the choice of materials lend COVANA products exceptional quality, performance and durability.

For more information, contact  
Covana\* or visit our Web site:

**covana.com**

**info@covana.com**

\*COVANA is a member of the Canimex Group,  
committed to excellence since 1969.

